

THE SMART CELL



The smart cell is the culmination of 4 years of research, design and development process which has now culminated in to a working prototype and endless opportunities.

FLEXIBILITY IN DESIGN

Full structural design and certification undertaken with interchangeable mould designs to suit a variety of prisons.

100% AUSTRALIAN MADE

Ready for mass production. Fully scalable solution from 2 to 2000 units. We can meet any project requirements both in Australia and Internationally.

COST EFFECTIVE

Prefabricated building gives flexibility, offers great on site time savings & lower costs and ensures a factory quality finish.

OVERALL PERFORMANCE (ESD)

Thermally broken cell windows, recycled concrete, LED Lighting which provides thermal benefits and excellent acoustic performance.

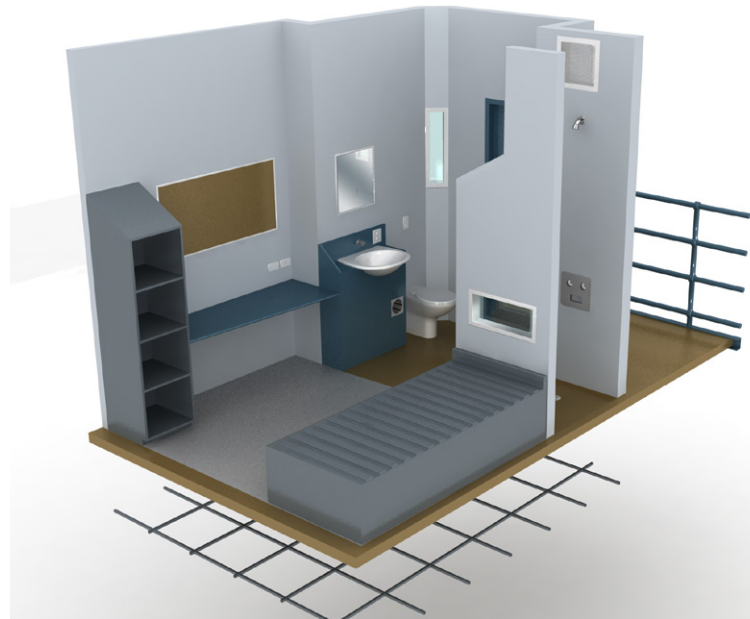

CAPABILITIES



SAFETY IN DESIGN

First floor handrail pre-installed

TIME

Complete cell including floor and lid. Can eliminate months of on site work

QUALITY

Factory finished and Quality Assured system with a locked door, defect free delivery

SPEED

Vast reduction in overall project production along with significant reduction site labour requirement



WHY SMART CELL?

Steelvision has developed the ability to manufacture a prefabricated prison cells which adheres to the Victorian Guidelines, for both single and double cells.



These, complete with fixed furniture are shipped to site "locked" for minimal damage during the building process.

For builders this cell offers the benefit of faster Installation, less damage with the delivery cost being comparable to traditional systems.

MULTI STORY SMART CELL

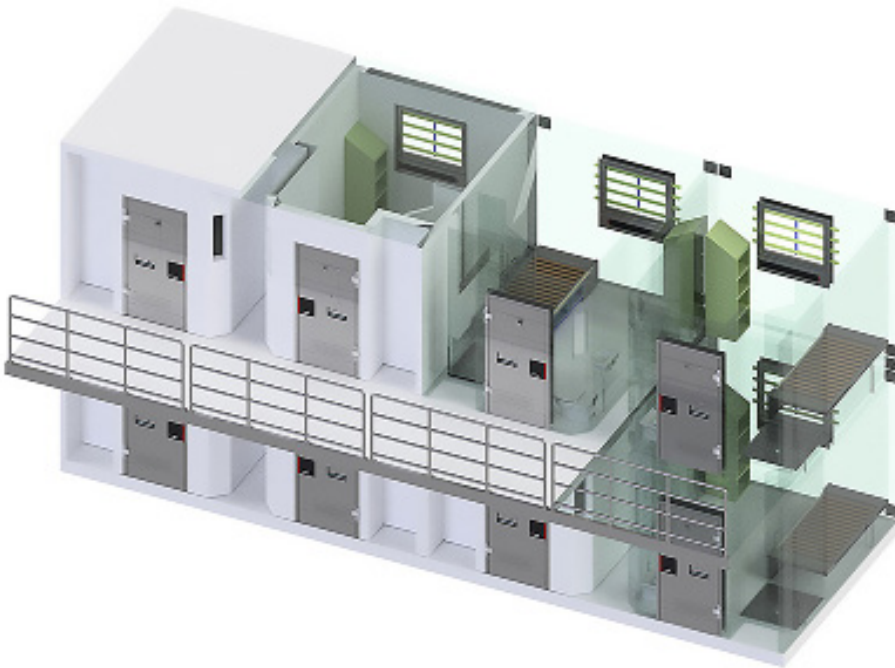

- Multi storey Prefabricated Prison Cells available as design can be stacked
- The first floor slab lid is constructed as a separate unit
- All internal finishes including painting can be included if required
- Vertical preparation allows for more accurate install of electrical, data and security conduits
- Time saving install resulting in short and long term cost benefits

EXCITING NEW DEVELOPMENTS

- Option secured on a new 7000m² manufacturing facility in the Latrobe Valley with 30,000m² of yard space
- Internal manufacturing capabilities including our own ranges of doors, windows, precast concrete, structural steel and furniture
- The “Double Module” – 2 mirrored cells with one pour



THE IN HOUSE TEAM

- Internal design team and drafting resources, 3D integrated design software and solutions
- Agility for large and small scale solutions, project values to date range for \$250k to \$14m. Forecast 2018 Turnover \$40m +
- Small family business ideology with large national capabilities
- Quality Manager and support team to ensure a first class process and finish
- Partnership with Coastal and Composite Global gives us a start to finish total Project solution



FULLY CERTIFIED

All products are strictly in accordance with the Cell fire & Safety Guidelines, however not restrained by this flexibility in required.

Call Us: 03 9580 8700
Office Address: U3/270 Lower Dandenong Road Mordialloc VIC 3195
Production Facility: 69-71 Macbeth Street Braeside VIC 3195
Website: www.steelvision.com.au